

Modern Chef
La cocina perfecta

Lista de piezas Mod. MGK165B

Baño María Eléctrico



www.metalgas.com.do

Más de 35 años acompañando tus negocios

 Av. Luperón no.5, Zona Industrial de Herrera
 Autopista de San Isidro, 1^{er} nivel Coral Mall. Santo Domingo Este

Modern Chef

La cocina perfecta

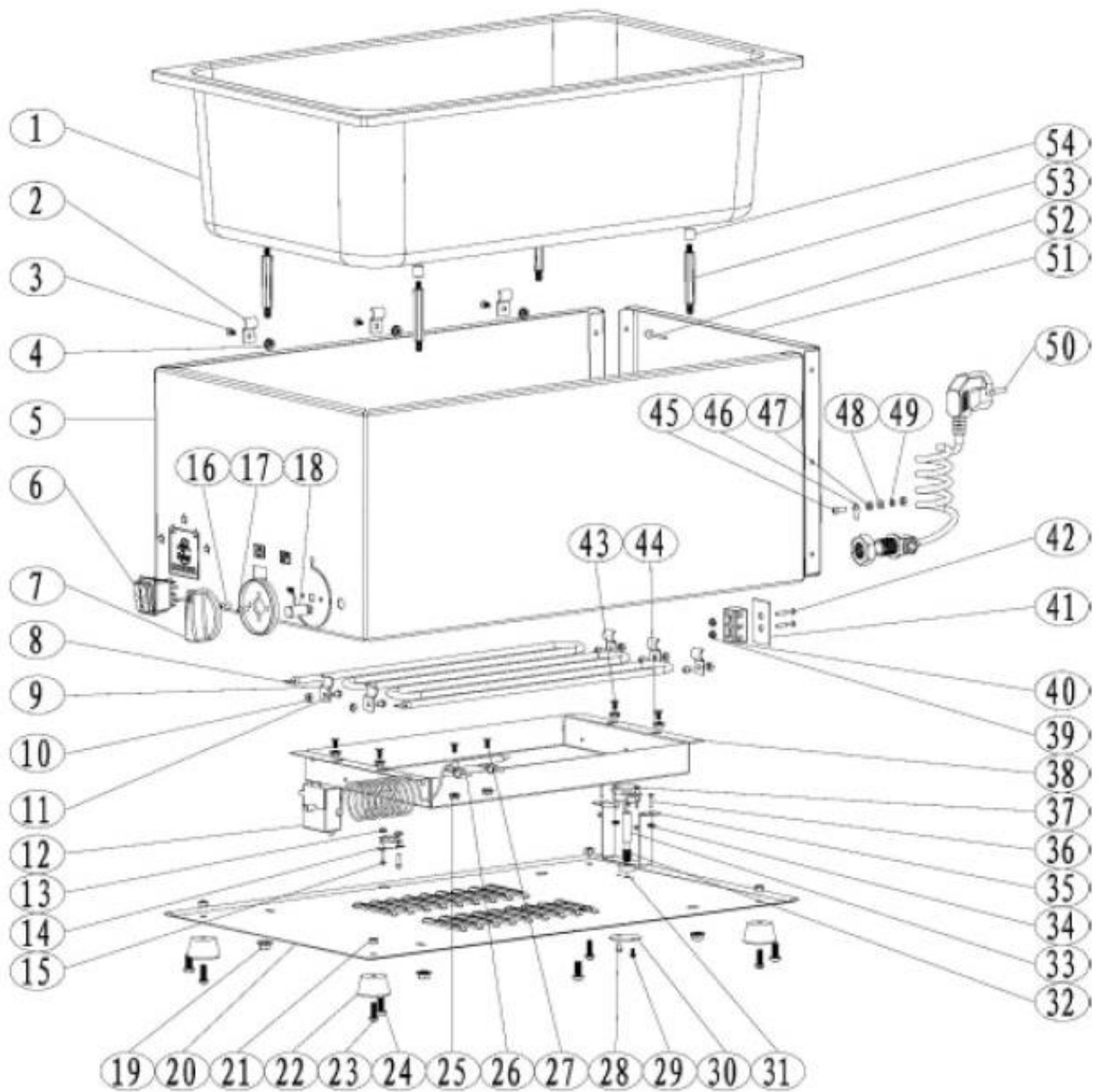

Más de 35 años acompañando tus negocios

📍 Av. Luperón no.5, Zona Industrial de Herrera
📍 Autopista de San Isidro, 1^{er} nivel Coral Mall. Santo Domingo Este

Modern Chef

La cocina perfecta

NO	NOMBRE	CANTIDAD			
1	Water pan	1	27	Stainless steel/spot welded bolts	1
2	Pipe card 1	4	28	Aluminum flat round head core pulling rivet	1
3	Stainless steel/spot welded bolts	4	29	Galvanized/cross groove pan head self tapping screw	1
4	Ordinary carbon steel/galvanized hexagonal flange nut	3	30	Mushroom slice cover plate machine added	1
5	Outer frame (American standard)	1	31	Mushroom slices	1
6	Rocker switch	1	32	Stainless steel pagoda spring	1
7	knob	1	33	Reset rod 48/56/68mm	1
17	Bathing pool Knob Washer	1	34	Ordinary carbon steel/galvanized hexagonal flange nut	2
8	Heating tube	1	35	Reset rod bracket	1
9	Pipe card 1	6	36	Stainless steel spot welding bolt	2
10	Ordinary carbon steel/galvanized hexagonal flange nut	5	37	Temperature control disconnected	1
11	Stainless steel/cross groove large flat head screw	5	38	Heating tube tray machine after adding	1
12	Temperature controller EGO	1	39	Ordinary carbon steel/galvanized hexagonal flange nut	2
13	Ordinary carbon steel/galvanized hexagonal flange nut	2	40	Ordinary carbon steel/galvanized hexagonal flange nut	1
14	Temperature control reset plate	1	41	Ceramic wiring terminal	1
15	Stainless steel spot welding bolt	2	42	Stainless steel spot welding bolt	2
16	Stainless steel/cross groove large flat head screw	2	43	Stainless steel/spot welded bolts	4
18	indicator light	1	44	Ordinary carbon steel/galvanized hexagonal flange nut	4
19	Ordinary carbon steel/galvanized hexagonal flange nut	4	45	Stainless steel/cross groove large flat head screw	1
20	Bottom plate (left side) after machining	1	46	Grounding aluminum plate	1
21	Ordinary carbon steel/galvanized hexagonal flange nut	4	47	Stainless steel hex nut	2
22	Large rubber feet	4	48	Stainless steel flat washer Class C	3
23	Ordinary carbon steel/galvanized/cross groove pan head screw	4	49	Stainless steel spring washer	3
24	Ordinary carbon steel/galvanized cross groove pan head self tapping screw	6	50	power cord	1
25	Ordinary carbon steel/galvanized hexagonal flange nut	1	51	Bathing pool sealing machine	1
26	Pipe card 1	1	52	Aluminum flat round head core pulling rivet	6
			53	Hexagonal screw	4
			54	Stainless steel spot welding screws	4

Un producto:

METALGAS, S.R.L.

Calidad, servicio y garantía

Más de 35 años acompañando tus negocios

 Av. Luperón no.5, Zona Industrial de Herrera
 Autopista de San Isidro, 1^{er} nivel Coral Mall. Santo Domingo Este